

AUTOCUT P 141

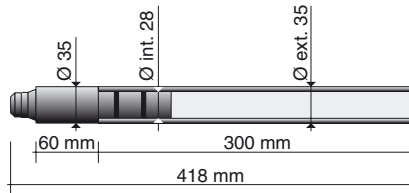

COMPLETE TORCH

Pt. No.	Description	Pack	Euro	D
PA0103	Plasma P 141 machine torch 6m	1	430,00	A
PA0104	Plasma P 141 machine torch 12m	1	520,00	C
PA0145	Plasma P 141 torch 6m central adaptor	1	470,00	A
PA0146	Plasma P 141 torch 12m central adaptor	1	550,00	C



TECHNICAL DATA

Voltage class	M
Standard length m	6
Air consumption	210 l/min
Air pressure	5 bar
Duty cycle 60%	140 A
Duty cycle 100%	100 A

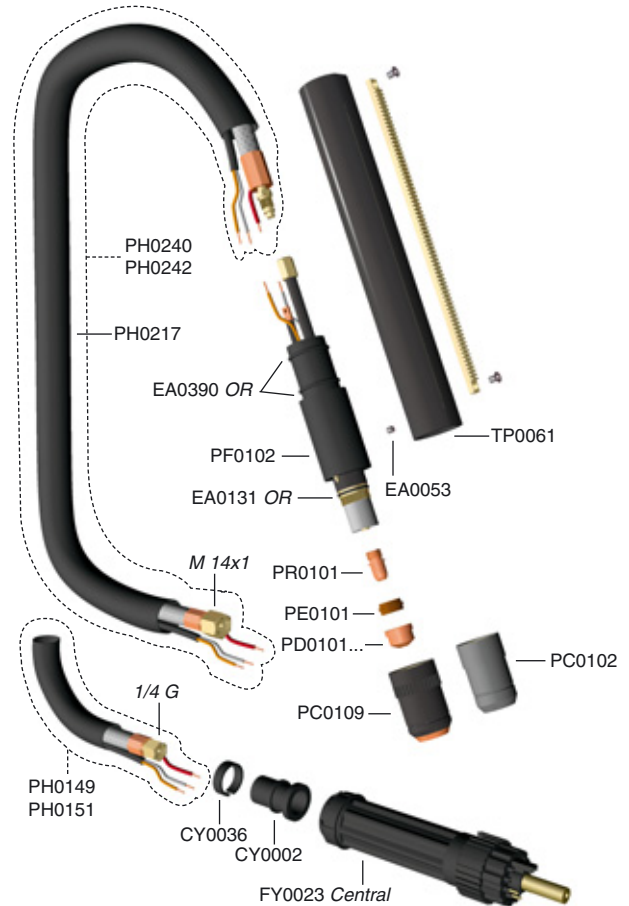
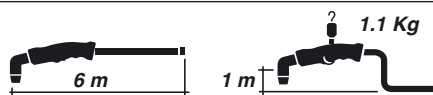

Pt. No.	Description	Pack	Euro	D
CY0035	Cable Support	10	1,10	B
CY0036	Cable Support	10	0,80	B
EA0053	Screw	50	0,10	B
EA0131	O-ring	10	0,50	A
EA0390	O-ring	10	0,50	B
FY0023	Male central adaptor	1	26,50	A
PC0101	Outside nozzle A 141	2	16,00	A
PC0102	Heavy Duty nozzle A 141	2	20,00	A
PD0101-11	Tip Ø 1,1 A 101 / A 141	10	1,75	A
PD0101-14	Tip Ø 1,4 A 101 / A 141	10	1,75	A
PD0101-17	Tip Ø 1,7 A 101 / A 141	10	1,75	A
PD0101-19	Tip Ø 1,9 A 101 / A 141	10	1,75	A
PE0101	Air diffuser A 101 / A 141	2	10,00	A
PF0102	Torch head P 141	1	212,00	A
PH0149	Cable assembly 6m central adaptor	1	104,00	B
PH0151	Cable assembly 12m central adaptor	1	181,00	C
PH0217	Outer cover 6m steel	1	155,00	C
PH0240	Cable assembly 6m M14x1 steel P 141	1	260,00	C
PH0242	Cable assembly 6m 1/4G steel	1	260,00	C
PR0101	Electrode A 101 / A 141	10	1,85	A
TP0061	Handle	1	75,00	B

The evolution of the A140, the best ratio between performance and price that is available on the market.

Main characteristics:

- wide range of accessories
- the design and realisation of the new "ERGO" handle, with more notable extras than previous ones:
 - a better - balanced grip and handle lightening, which makes it notably less tiring
 - improved ergonomoy with a greater distance between the hand and the plasma arm, with consequent decreasing of exposure to heat
- the ball joint - Trafimet patent - which gives excellent flexibility at the connection point between the cable and the handle
- DOUBLE ELECTRICAL AND MECHANICAL SAFETY.

Plasma Range

trafimet®